

**Earth Boss**



Earth Boss are manufactured from High Tensile Mild Steel, zinc plated to avoid corrosion.  
Supplied with SS/Phosphor bronze studs, bolts, spring and plain washer

Material : Mild steel

Length mm	Dia mm	Thread Dia	Cat Ref
30	38	3/8"	CEB-30
50	50	1/2"	CEB-50

**Cable Cleat Clamp**

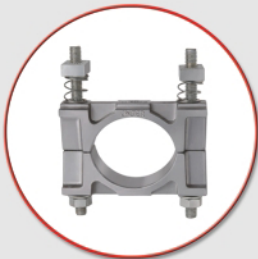

Material : Al. Alloy LM6  
BS: 1490  
Stainless steel bolt with nut plain and spring washer  
Liner: Rubber

Size	Cat. No.
H50-60	C50-60
H60-70	C60-70
H70-80	C70-80
H80-90	C80-90
H90-100	C90-100