

**Brass Extruded
Cable Glands : Type BW**

Application :

For use in dry, indoor situations

Function :

All glands offer clamping of the armour or braided

Standard

: BS 6121: Pt 1

Mechanical

: Provides retention of armour or braid

Size

: BW 16 to 75

Material

: BS 2874 (Cz121) Brass

Finish

: Matt / Nickel

Gasket kits

: Seal rated to IP66
: BW Gland, Shrouds, Locknut and Earth tag

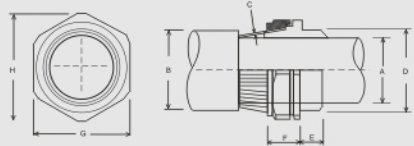

Cable Dimensions Accommodated				Gland Reference		Gland Dimensions					Accessories			
Diameter		Overall Diameter	Armour Wire Diameter	C	Size	Design No	ISO Entry Thread		Approx. Length From Shoulder	Hexagon Size		Brass Backnut No.	Shoulder Design No.	
Under Armour A	Max. mm						Dia	Length		Across Flats	Across Corners		PVC	PCP
Min mm	Max. mm	Min mm	Max mm	mm			D mm	E mm	F mm	G mm	H mm			
-	8.6	-	13.2	0.9	16	CBW16	16	10	21	20.8	23.6	AA 51	01	01
-	11.6	-	15.8	0.9/1.25	20S	CBW20S	20S	10	24	22.0	24.9	AA 53	02	02
-	13.9	-	20.8	0.9/1.25	20	CBW20	20	10	25	27.0	30.5	AA 53	03	03
-	19.9	-	27.2	1.25/1.8	25	CBW25	25	10	26	37.6	42.2	AA 55	05	05
-	26.2	-	33.5	1.6/2.0	32	CBW32	32	10	28	47.3	53.6	AA 56	06	06
-	32.1	-	39.9	1.6/2.0	40	CBW 40	40	15	25	50.0	57.0	AA 57	07	07
-	38.1	-	46.2	2.0/2.6	50S	CBW 50	50	15	36	70.1	77.2	AA 59	09	09
-	44.0	-	52.6	2.0/2.6	50	CBW 63	63	15	30	80.0	87.4	AA 61	11	11
-	55.9	-	65.3	2.5	63	CBW 61	75S	15	40	86.0	95.0	AA 63	13	13
-	67.9	-	78.0	2.5	76	CBW 75	75	15	40	98.8	109.2	AA 63	13	13