

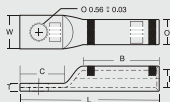

Compression Terminal Copper Long Barrel One Hole (AWG)

- ETP copper alloy c11000 per ASTM SPEC B188 copper tube
- Electro tinned plated



Product Ref.	Conductor Size	Colour Code	Dimensions inches						
			O	I	B	W	T	C	L
CAT 1000-2	1000 MCM	WHITE	1.504	1.170	2.94	2.17	0.32	2.12	6.00
CAT 750 -2	750 MCM	BLACK	1.302	1.030	2.81	1.89	0.27	1.94	5.44
CAT 600 -2	600 MCM	GREEN	1.185	0.920	2.63	1.69	0.27	1.75	5.15
CAT 500 -2	500 MCM	BROWN	1.064	0.830	2.19	1.54	0.23	1.30	4.20
CAT 350 -2	500 MCM	BROWN	1.064	0.830	2.19	1.52	0.23	1.50	4.36
CAT 400 -2	400 MCM	BLUE	0.953	0.758	2.06	1.38	0.19	1.50	4.20
CAT 350 -2	350 MCM	RED	0.877	0.700	1.94	1.28	0.18	1.12	3.65
CAT 300 -2	300 MCM	WHITE	0.815	0.649	2.00	1.19	0.16	1.12	3.56
CAT 250 -2	250 MCM	YELLOW	0.753	0.594	1.63	1.09	0.16	1.12	3.18
CAT 4/0 -2	4 / 0 STR	PURPLE	0.691	0.545	1.63	1.00	0.14	1.08	3.00
CAT 3/0 -2	3 / 0 STR	ORANGE	0.618	0.487	1.50	0.91	0.13	1.08	2.87
CAT 2/0 -2	2 / 0 STR	BLACK	0.563	0.446	1.53	0.82	0.12	0.88	2.72
CAT 1/0 -2	1 / 0 STR	PINK	0.515	0.391	1.41	0.75	0.11	1.08	2.71
CAT 1/0 -2	1 / 0 STR	PINK	0.515	0.391	1.41	0.74	0.12	0.75	2.42
CAT 1 -2	1 STR	GREEN	0.462	0.354	1.41	0.68	0.10	0.75	2.42
CAT 2 -2	2 STR	BROWN	0.416	0.307	1.28	0.60	0.11	0.75	2.25
CAT 3 -2	3 STR	WHITE	0.377	0.284	1.22	0.57	0.09	0.70	2.25
CAT 4 -2	4 STR	GRAY	0.340	0.248	1.16	0.50	0.09	0.56	1.92
CAT 6 -2	6 STR	BLUE	0.292	0.195	1.16	0.45	0.08	0.56	1.92
CAT 4 -2	4 STR	GRAY	0.340	0.248	1.16	0.50	0.09	0.88	2.25